



Archived resources

For further resources and
documentation please visit us:
www.cinos.net



EYE-LCD-8000-LE-500/-700

80" LCD MONITOR WITH
EDGE-LED BACKLIGHT



) DISPLAY CHARACTERISTICS

- Professional 80-inch LCD monitor with Edge-LED backlight technology (ca. 203 cm) for Landscape or Portrait installation
- Two different brightness versions available (500 or 700 cd/m²)
- Full HD Resolution (1920 × 1080 Pixel)
- Low installation depth, slim bezel design
- Ideal for sophisticated applications in control room, conferencing or digital signage
- Robust metal housing (standard black RAL9005, different RAL colours available on request)

) PICTURES



Robust & slim design

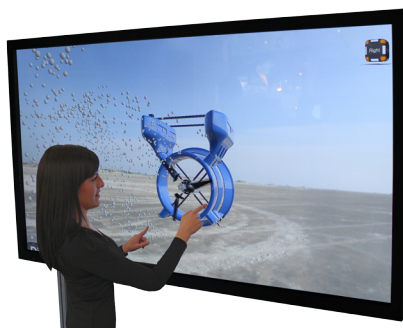

Optional with touch surface



Customised housing colours possible

) DRAWING

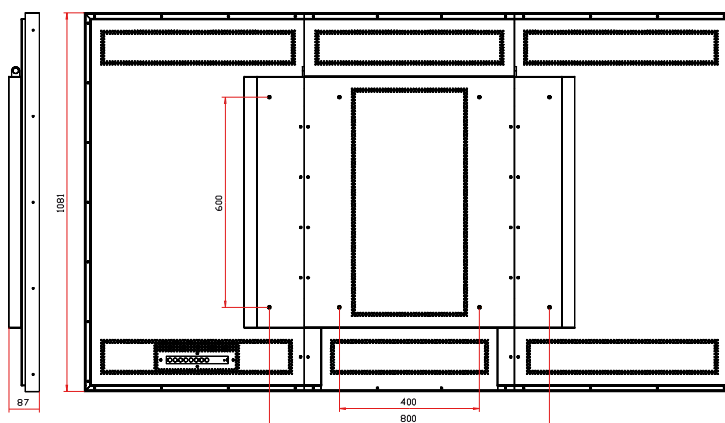
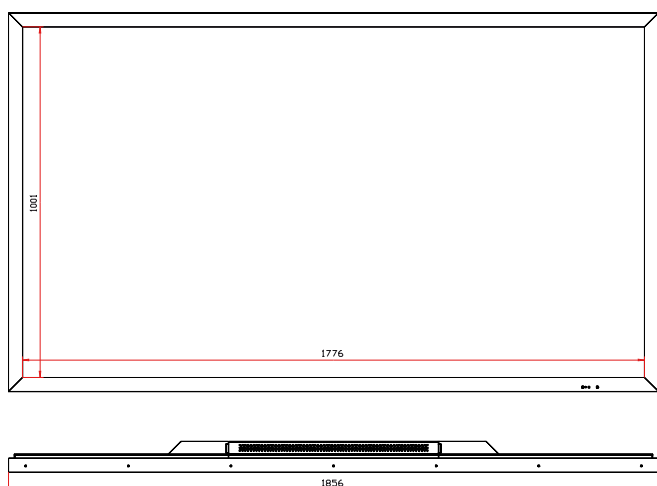

Unit: mm



EYE-LCD-8000-LE-500/700

80" LCD MONITOR MIT EDGE-LED BACKLIGHT

) TECHNICAL SPECIFICATIONS

LCD SCREEN	EYE-LCD-8000-LE-500	EYE-LCD-8000-LE-700
Backlight Technology:	Edge-LED	
Max. Image Resolution:	1920 × 1080 (full HD)	
Colours:	16.7M (8bits-true)	
Viewing Angle:	176° / 176° (H/V)	
Response Time:	4 ms	
Contrast Ratio:	5000:1	
Brightness:	typ. 500 cd/m ² (min. 400 cd/m ²)	typ. 700 cd/m ² (min. 560 cd/m ²)
Pixel Pitch:	0.9225 (H) × 0.9225 (V) mm	
24/7 Operation [®] :	Yes (recommended operation: 20/7)	

CONNECTORS & CONTROL

Signal Connectors:	1× DVI / 2× HDMI / 1× VGA / 1× S-Video / 1× C-Video
Audio:	2× Cinch / 2× MiniJack 3,5mm
Control Interface:	RS232 (9-pin D-Sub), IR remote control, rear panel control buttons

POWER SUPPLY

Input Voltage:	90-264V 50/60Hz; integrated mains adapter
Power Consumption:	≤ 320W (typ.)

ENVIRONMENTAL

Operating Temperature:	0 – 40 °C
Humidity:	max. 95%RH

MECHANICAL

Screen Diagonal:	80 inch (ca. 203 cm)
Screen Area:	1771.2 (H) × 996.3 (V)
Dimensions (W×H×D):	1856 × 1081 × 87 mm
Bezel:	ca. 40 mm (all sides)
Weight:	approx. 78 kgs

OPTIONS

Touch:	Optical touch surface with up to 32 simultaneous touch points
Installations	Different wallmounts and stands available
Housing Colour:	Customised finishing available on request (standard colour black RAL9005)

ORDER INFORMATION

Article Number:	0000017169	0000016995
-----------------	------------	------------

[®]Electronic components designed for 24/7 operation. Prolonged display of static image contents may affect the display quality of the device. These effects do not affect the functionality of the device and are therefore not considered as defects in terms of our warranty conditions.



eyevis GmbH

Hundsschleestr. 23 • 72766 Reutlingen • Germany
 Phone: + 49 (0) 7121 43303 - 0 • Fax: + 49 (0) 7121 43303 - 22
 www.eyevis.de • info@eyevis.de

As at: 21.10.2013/V1.5 • Subject to change!

All trademarks and registered trademarks are the property of their respective owners. Copyright © 2012 eyevis GmbH. All rights reserved.

For further resources and
documentation please visit us:
www.cinos.net